

PATIOVA

LIVE INSIDE OUT



POLY FOOTSTOOL ASSEMBLY MANUAL

Parts List

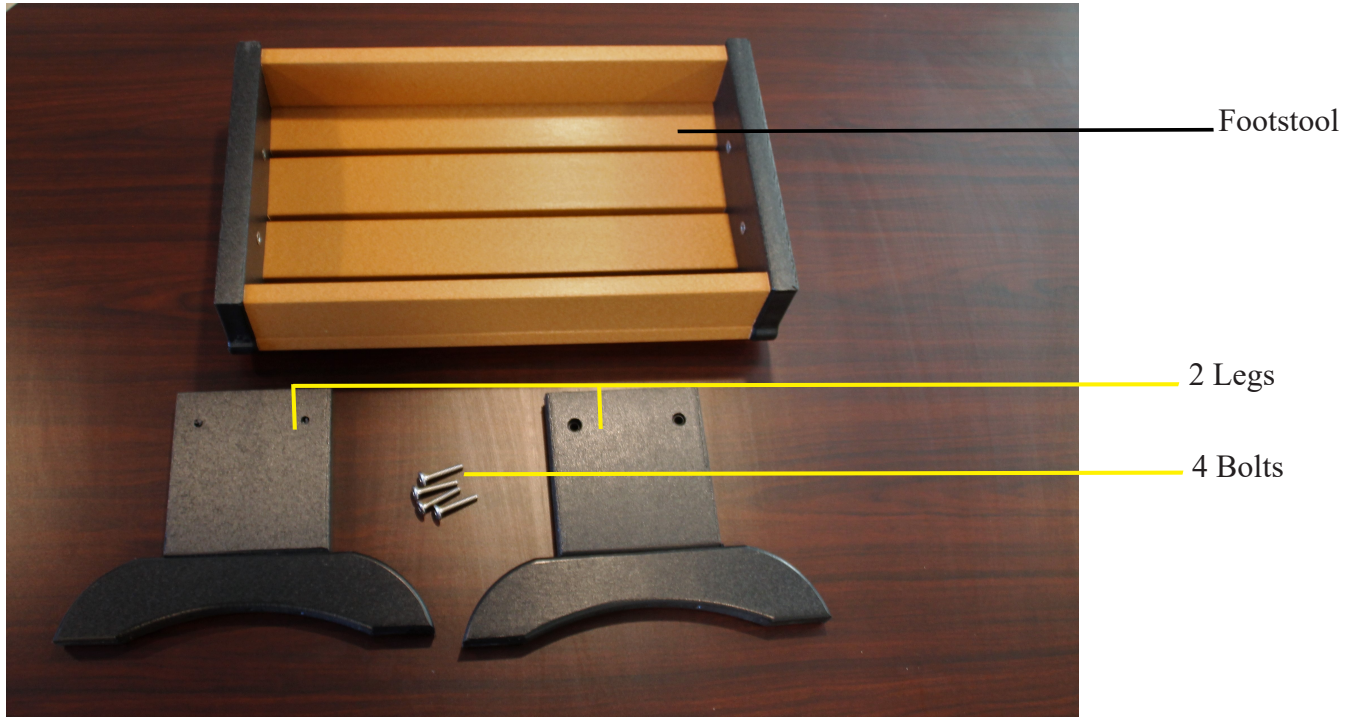

Tools Required For The Job (Included)



5/32" Hex Key

*NOTE: This Hex Key is used to tighten all the screws used in the assembly process.

Step:1

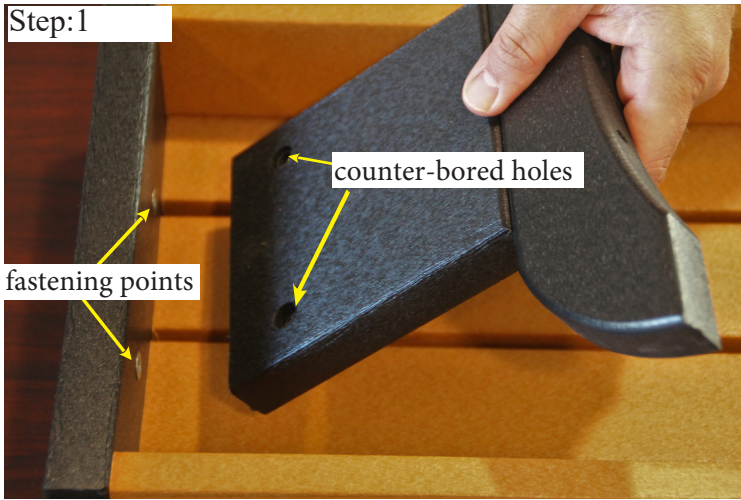

Place footstool top down on a clean, smooth surface. Be sure counter-bored holes are placed towards the fastening point.

Step:2



Fasten leg to footrest using bolts provided. Repeat this step at all four fastening points.

Step:3



Your assembly is now complete! Be sure four bolts are properly tightened.



This footrest is designed so it can easily slide under the chair for convenient storage.



PATIOVA

LIVE INSIDE OUT

6649 North Moscow Road
Parkesburg, PA 19365
610-857-1359
patiova.com
info@patiova.com