

Natural Cedar  
**VERTICAL GARDEN BED**  
Assembly Manual

GARDEN BED KIT CREATES UP TO 8 SQ.  
FT. OF GARDEN SPACE!



**YardCraft**<sup>®</sup>  
rediscover life outdoors



### *Vertical Garden Bed*

- 5 cubic feet of soil to fill
- Creates 8 square feet of garden area

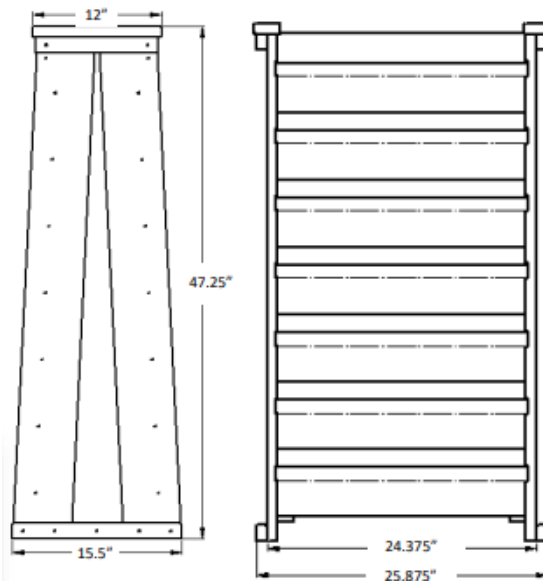

Before you begin

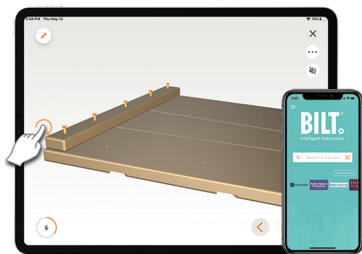

3D-GUIDED INTERACTIVE ASSEMBLY  
INSTRUCTIONS CAN BE FOUND ON **BILT**<sup>®</sup>

DOWNLOAD THE **FREE** APP  
SCAN THE QR CODE TO FIND YOUR PRODUCT



# Vertical Garden Bed Assembly Manual

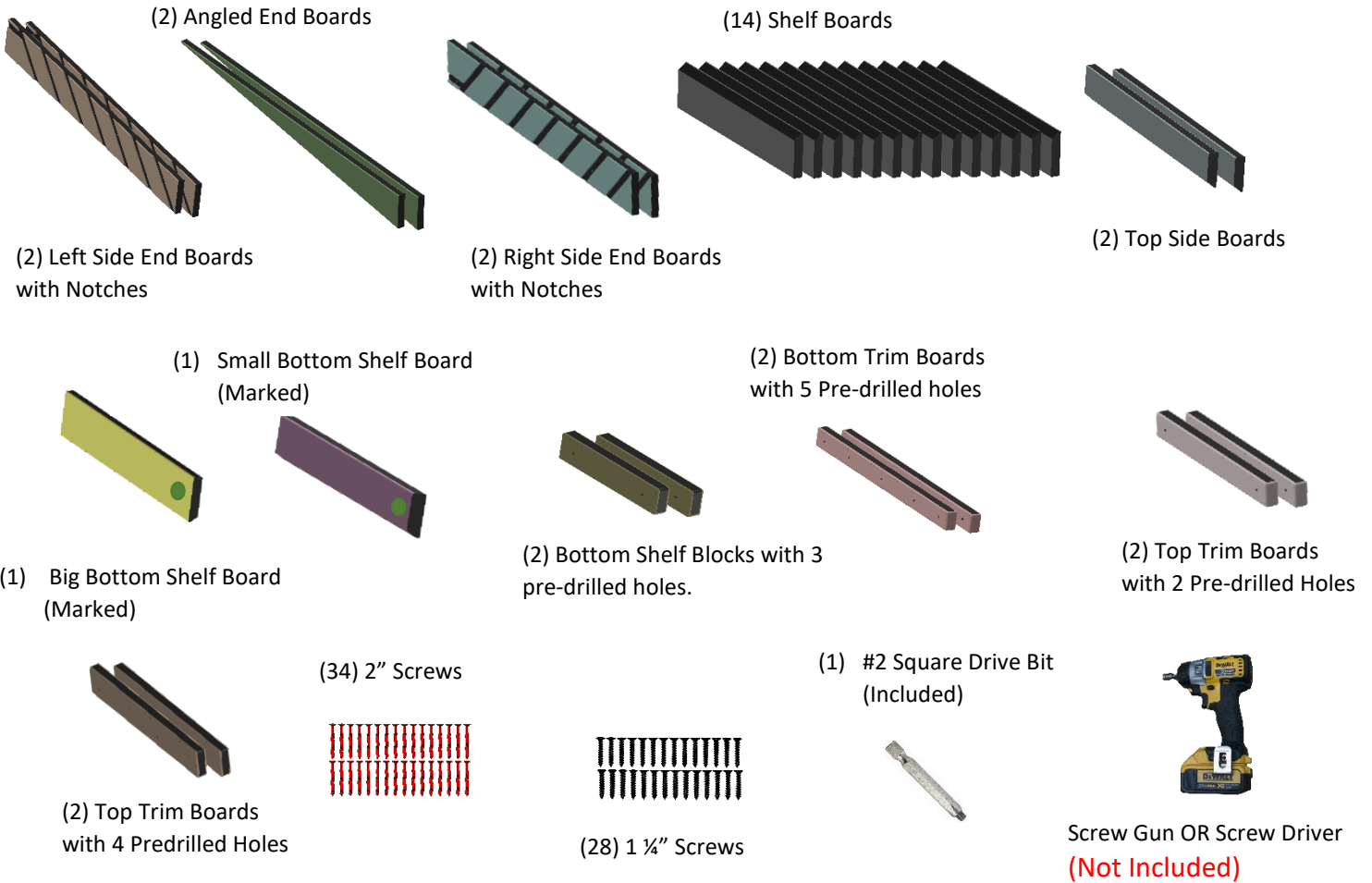

Step 1: Make sure top notches are on the outside and shelf notches angle down into the center as seen in Step 5. Fasten Angled End Board to Left Side End Board with (1) 2" Screw.

Step 2: Make sure all end boards are tight together and fasten bottom trim board with 5 pre-drilled holes and top trim board with 2 pre-drilled holes with 1 1/4" screws as shown.

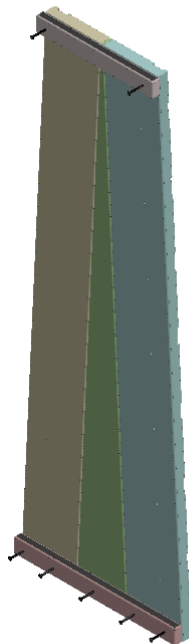
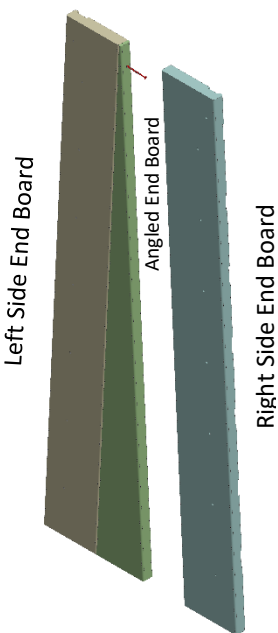

Repeat Step 1 & step 2. There should be 2 panels as shown here.

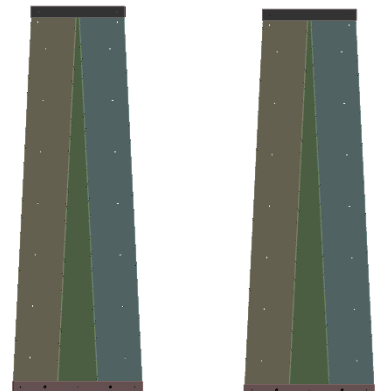

## Questions? Issues with Damaged or Missing Parts?

In order to best assist you, please contact YardCraft directly, NOT a third part retailer, with any questions regarding our products, damages, or replacement parts. This will help you get what you need as quickly as possible! Call us at 866-210-9273 or Email us at [info@yardcraft.com](mailto:info@yardcraft.com)!

# Vertical Garden Bed Assembly Manual

Left Side Panel

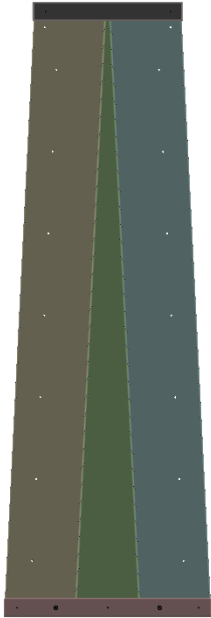

Right Side Panel

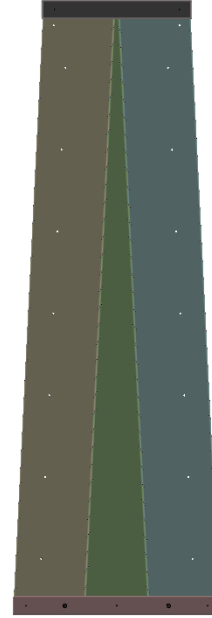

Step 3: Insert Shelf Boards in the bottom notch as shown. Fasten from each side with 2" screws into pre-drilled holes.

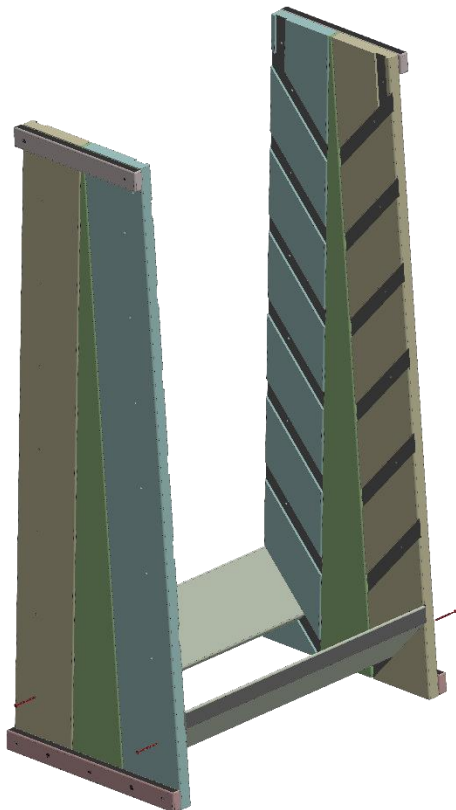

Step 4: Assemble marked big bottom shelf board & marked small bottom shelf board. Center the bottom shelf blocks on the big and small bottom shelf boards and fasten with 1 1/4" screws into pre-drilled holes as shown.

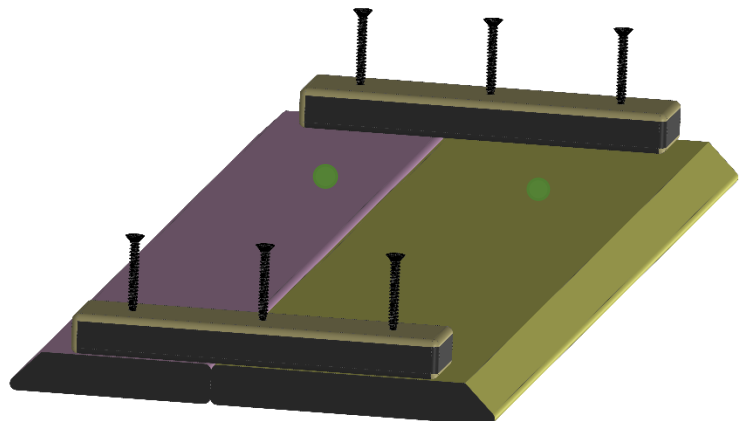

# Vertical Garden Bed Assembly Manual

Step 5: Place bottom shelf panel in place with blocks facing down as shown. This shelf is free floating.

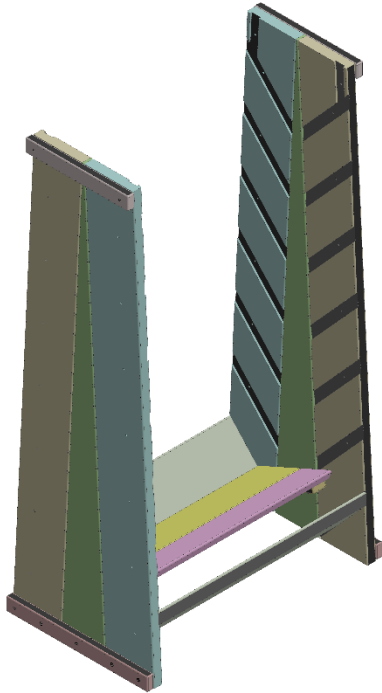

Step 6: Insert the rest of the shelf boards into notch and fasten from each end with 2" screws into pre-drilled holes

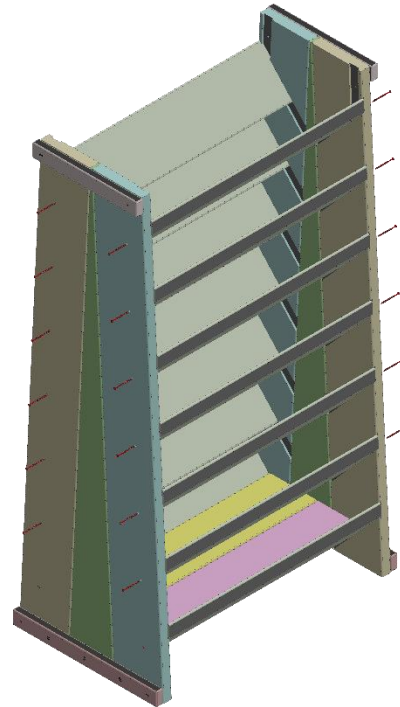

Step 7: Insert top Side Boards into notch and fasten with 2" screws on each side into predrilled holes

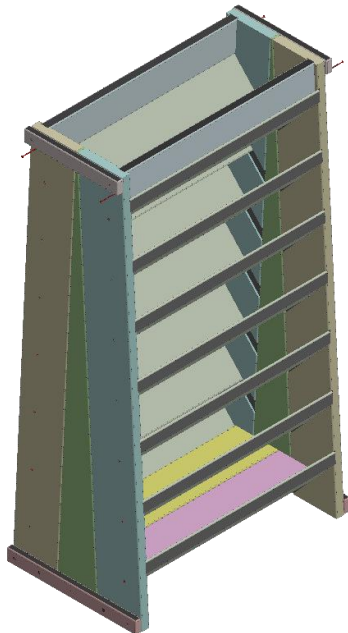

Last Step: Place top trim board with 4 pre-drilled holes, on top, centered both ways and fasten with 1 1/4" screws

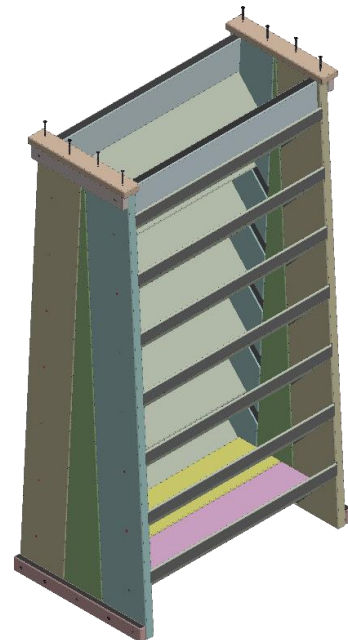

*YardCraft.com*

*Info@YardCraft.com*

*271 S Shirk Road New Holland, PA 17557*

*1-844-442-1615*